



Features



Lined Butterfly Valve have split body design, integral disc & stem, rugged construction & high functionality. They are mostly used in corrosive services like acids etc. These valves have low torque, tight sealing & are easy to install and maintain.

Design Standard : API 609 CAT A

Testing Standard : API 598

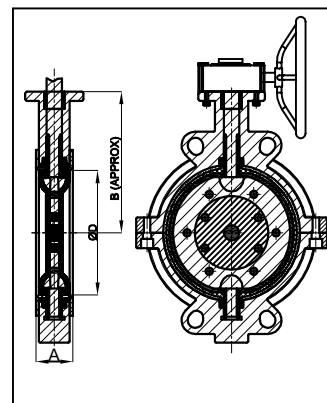

Test Pressure in Bar

		Class	150
Hydro Test	Body		15
	Seat		11
Spark Test	Body & Flapper		20 Kv

Size Class - 150

mm	in	A	B (Approx.)	ØD
50	2	43	121	51
65	2½	46	133	64
80	3	46	145	76
100	4	52	140	102
125	5	56	189	127
150	6	56	175	152
200	8	60	216	203
250	10	68	265	254
300	12	78	298	305
350	14	78	325	337
400	16	102	370	387

All Dimensions are in "mm"

MATERIALS

Body	ASTM A 216 Gr. WCB, ASTM A 351 Gr. CF8 / CF8M, ASTM A 352 Gr. LCB, Hast Alloy, Super Duplex, Alloy 20
Flapper (Disc & Shaft)	ASTM A 216 Gr. WCB, ASTM A 351 Gr. CF8 / CF8M, ASTM A 352 Gr. LCB, Hast Alloy, Super Duplex, Alloy 20
Body & Flapper Lining	PFA, FEP
Operations	Manual Lever, Gear Box, Actuator.

NOTE:

- Please specify flow medium, working pressure, temperature & service conditions.
- Other materials not mentioned above are available on request.
- Valve Sizes from DN 50 to DN 150 are Manual Lever Operated.
- Valve Sizes above DN 150 are Gear Operated.
- Valve Sizes from DN 50 to DN 150 are provided with two lug locations.
- Lining Thickness minimum 3 mm.
- Raised Face without serration.
- Face to Face standard as per API 609 CAT A
- End Connection wafer to suit between ASME B 16.5 flanges.
- In the process of continuous improvement of products, the data given herein is subject to change.

T.S. PUMPS & VALVES PVT.LTD.



B-490, Industrial Estate, Gokul Road,
Hubballi-580030, Karnataka, INDIA
Phone : +91-836-2331096 / 0836-2210615
Email : tsvalves9@gmail.com / tspv9@airtelmail.in
Website : www.tsvalvesindia.com

TSPV: CAT-017/R-00
Date : 22/02/2021