



Features



Lined Plug Valve provide excellent performance in various industries. Corrosion resistant lining materials make them ideal for corrosive slurry applications. Also it provides low operating torque

Design Standard : API 599
Testing Standard : API 598

Test Pressure in Bar

	Class	150
Hydro Test	Body	15
	Seat	11
Spark Test	Body & Plug	20 Kv

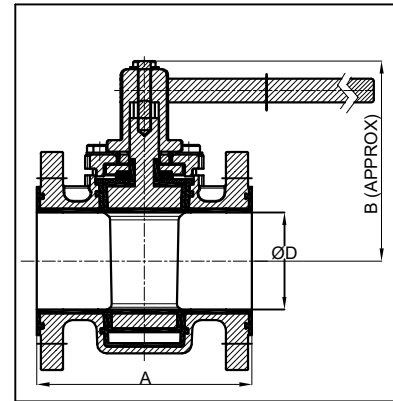

Size		Class - 150		
mm	in	A	B (Approx.)	ØD
15	1/2	108	90	13
20	3/4	117	95	19
25	1	127	108	25
40	1 1/2	165	115	38
50	2	178	160	51
65	2 1/2	190	165	64
80	3	203	170	76
100	4	229	240	102
150	6	267	285	152
200	8	292	330	203

All Dimensions are in "mm"

MATERIALS

Body & Cover	ASTM A 216 Gr. WCB, ASTM A 351 Gr. CF8/ CF8M/ CF3/ CF3M.
Plug	ASTM A 216 Gr. WCB, ASTM A 351 Gr. CF8/ CF8M/ CF3/ CF3M.
Body & Plug Lining	PFA, FEP
Fasteners	ASTM A 193 Gr. B7, ASTM A193 B8/8M
Operation	Manual Lever, Gear Box, Actuator.

NOTE:

- Please specify flow medium, working pressure, temperature & service conditions.
- Other materials not mentioned above are available on request.
- Valve Sizes from DN 15 to DN 100 are manual Lever Operated.
- Valve Sizes from DN 150 & above are Gear Operated.
- Lining Thickness minimum 3 mm.
- Raised Face without serration.
- Face to Face standard as per ASME B 16.10
- End Connection as per ASME B 16.5
- In the process of continuous improvement of products, the data given herein is subject to change.

T.S. PUMPS & VALVES PVT.LTD.



B-490, Industrial Estate, Gokul Road,
Hubballi-580030, Karnataka, INDIA
Phone : +91-836-2331096 / 0836-2210615
Email : tsvalves9@gmail.com / tspv9@airtelmail.in
Website : www.tsvalvesindia.com

TSPV: CAT-014/R-00
Date : 22/09/2020