



# T. S. PUMPS AND VALVES PVT. LTD.

## CAST STEEL GLOBE VALVES

CLASS: 150, 300 & 600

### Features

Heavy duty OS & Y type, bolted bonnet, rising stem , rising hand wheel , renewable - seat ring for Carbon steel valves , integral for Stainless steel valves. Valves with most advanced design features providing the ultimate in reliability.

Design Standard : BS 1873, BS EN ISO 15761  
Testing Standard : API 598 / BS EN 12266-1

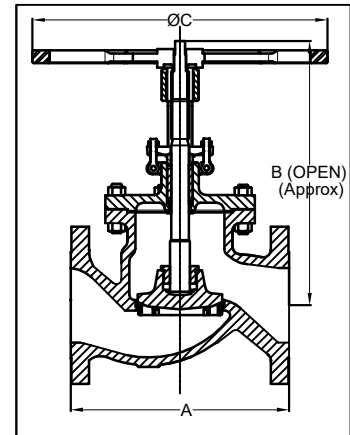
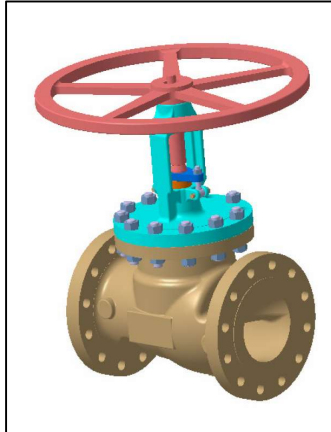

### Test Pressure in Bar

		Class 150	Class 300	Class 600
Hydro Test	Shell	30	76	156
	Seat/ Back Seat	22	56	113
Air Test	Seat	07	07	07

Size		Class - 150				Class - 300				Class - 600			
mm	in	A	B	ØC	Wt *	A	B	ØC	Wt *	A	B	ØC	Wt *
15	1/2	108	160	100	3.2	152	160	100	4.0				
20	3/4	117	170	100	04	178	170	100	5.0				
25	1	127	176	100	06	203	176	150	7.5				
32	1 1/4	140	152	150	11.5	216	152	150	15				
40	1 1/2	165	152	200	12	229	152	200	15.5				
50	2	203	295	200	14.5	267	295	200	17.2	292	330	250	41
65	2 1/2	216	290	200	30	292	351	250	35	330	347	300	56
80	3	241	345	250	36	318	360	300	46	356	408	450	71
100	4	292	349	300	52	356	413	450	73	432	480	600	122
125	5	356	410	300	77	400	471	450	95	508	595	♦	271
150	6	406	450	450	92	444	567	600	166	559	1030	♦	352
200	8	495	535	600	163	559	800	♦	205	660	1150	♦	628
250	10	622	815	♦	242	622	1235	♦	450	787	1255	♦	853
300	12	698	900	♦	283	711	1220	♦	735	838	1330	♦	1034

♦ Bevel Gear Actuators Mandatory

All Dimensions are in "mm"

### MATERIALS

Body & Bonnet  
Disc & Seat Ring  
Stem, Gland & Bonnet Bush  
Yoke Sleeve  
Gland Packing  
Gasket  
Stud / Nut  
Yoke & Hand Wheel  
Surface Protection for Carbon Steel Valves

ASTM A 216 Gr. WCB, ASTM A 352 Gr. LCB, ASTM A 351 Gr. CF8/CF8M/CF3/CF3M  
WCB with 13% Chrome Overlay/ ST on seal faces, ASTM A 351 Gr. CF8/CF8M/CF3/CF3M.  
ASTM A276 TYPE 410 / 304 / 316  
SG Iron /ASTM A 439 Gr.D2. (Ni-Resist)  
Grafoil  
Spiral Wound 304 / 316 Grafoil  
ASTM A 193 Gr. B7 / ASTM A 194 Gr. 2H  
Carbon Steel & MI / SG Iron  
Prime Coat:Chlorine free with modified alkyd resin unobjectionable in physiological and toxicological respects. Additional external coating:Silver Streak aluminium paint

### NOTE:

- \*Net Wt in Kg. approx. (without obligation).
- Please specify flow medium, working pressure, temperature & Service conditions.
- Other materials not mentioned above & higher sizes are available on request
- Face to Face as per ASME B 16.10
- End Connections as per ASME B 16.5
- Butt-Weld End to ASME B 16.25
- Ring Joint, Large or Small tongue & Groove flanges are available on request.
- Valves can be supplied with IBR, Locking Arrangement, Jacketed, Cryogenic, Stem Extension
- Valves can be supplied with Electric, Pneumatic or Gear Actuators
- In process of continuous improvement of products, the data given here in is subject to change

### T.S. PUMPS & VALVES PVT.LTD.

B-490, Industrial Estate, Gokul Road,  
Hubballi-580030, Karnataka, INDIA  
Phone : +91-836-2331096 / 2210615  
Email : sales@tsvalvesindia.com  
Website : www.tsvalvesindia.com



TSPV: CAT-002/R-01  
Date : 25/05/2017