



Features

Heavy duty bolted cover, with renewable seat ring. Cover mounted / Body mounted disc, valves with most advanced design features providing the ultimate in reliability.

Design Standard : MSS : SP81
Testing Standard : MSS : SP81

Test Pressure in Bar

	Class	PN 10
Hydro Test	Shell	10.0
	Seat	3.0

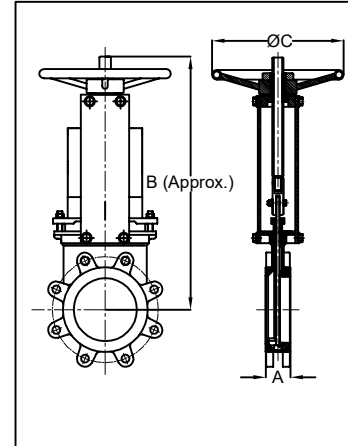

Size Class - 150

mm	in	A	B (Approx.)	ØC
50	2	48	354	200
65	2 1/2	48	380	200
80	3	51	412	200
100	4	51	472	200
125	5	57	490	300
150	6	57	543	300
200	8	70	644	300
250	10	70	744	400
300	12	76	861	400
350	14	76	949	400
400	16	89	1087	500
450	18	89	1204	500
500	20	114	1341	500
600	24	114	1560	500

All Dimensions are in "mm"

MATERIALS

Body	CI IS 210 Gr. FG 260, Ductile Iron, ASTM A 216 Gr. WCB, ASTM A 351 Gr. A 351 Gr. CF8/CF8M
Door (Gate)	ASTM A 240 Gr. 410, ASTM A 240 Gr.304, ASTM A 240 Gr. 316
Gland Packing	PTFE / Graphited Non Asbestos
Gland	Ductile Iron, ASTM A 216 Gr. WCB, ASTM A 351 Gr. A 351 Gr. CF8/CF8M
Stem	ASTM A 276 Gr. 410, ASTM A 276 Gr. 304, ASTM A 276 Gr. 316
Yoke	MS Fabricated
Yoke Sleeve	Ni Hard / Ductile
Hand Wheel	MS Fabricated
Operation	Hand Wheel, Chain Wheel, Gear Operated.

NOTE:

- Please specify flow medium, working pressure, temperature & Service conditions.
- Other materials not mentioned above & higher sizes are available on request.
- Unidirectional & Bidirectional can be offered.
- Face to Face as per MSS : SP81
- End Connections as per ASME B 16.5 #150 , BS10 Table D.
- Valves can be supplied with Electric, Pneumatic or Gear Operated.
- In process of continuous improvement of products, the data given here in is subject to change

T.S. PUMPS & VALVES PVT.LTD.



B-490, Industrial Estate, Gokul Road,
Hubballi-580030, Karnataka, INDIA
Phone : +91-836-2331096 / 2210615
Email : sales@tsvalvesindia.com
Website : www.tsvalvesindia.com

TSPV: CAT-010 R-00
Date : 27/05/2017