

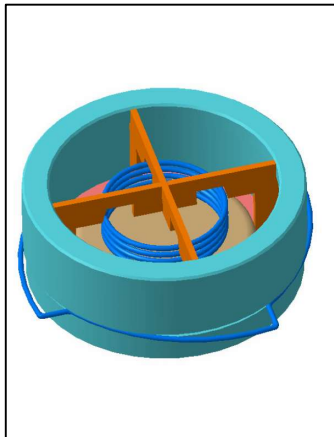

Features



These valves are general purpose valves that are stronger, lighter and smaller than conventional swing check valves & are therefore less expensive to install and maintain.

Design Standard: Manufacturer's Standard
Testing Standard: API 598 / BS EN 12266-1

Test Pressure in Bar

| | | Class 150 | Class 300 |
|------------|-------|-----------|-----------|
| Hydro Test | Shell | 30 | 76 |
| | Seat | 22 | 56 |

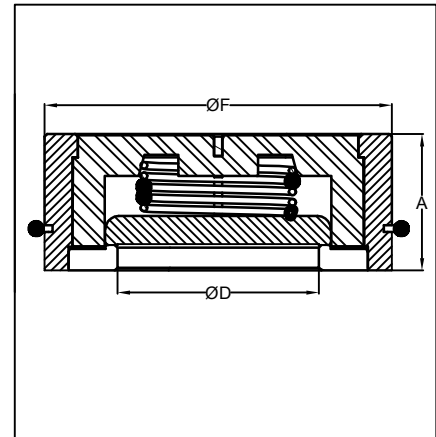

| Size | | Class - 150 | | | | Class - 300 | | | |
|------|-------|-------------|-----|------|-------|-------------|-----|------|-------|
| mm | in | A | ØD | ØF | Wt * | A | ØD | ØF | Wt * |
| 15 | 1/2 | 17 | 14 | 38 | 0.17 | 17 | 14 | 38 | 0.17 |
| 20 | 3/4 | 20 | 19 | 47 | 0.23 | 20 | 19 | 47 | 0.23 |
| 25 | 1 | 23 | 24 | 54 | 0.30 | 23 | 24 | 54 | 0.30 |
| 32 | 1 1/4 | 28 | 31 | 66.5 | 0.58 | 28 | 31 | 66.5 | 0.58 |
| 40 | 1 1/2 | 32 | 38 | 76 | 0.70 | 32 | 38 | 76 | 0.70 |
| 50 | 2 | 40 | 48 | 96 | 1.20 | 40 | 48 | 96 | 1.20 |
| 65 | 2 1/2 | 46 | 63 | 109 | 1.80 | 46 | 63 | 109 | 1.80 |
| 80 | 3 | 50 | 76 | 131 | 2.60 | 50 | 76 | 131 | 2.60 |
| 100 | 4 | 60 | 98 | 162 | 4.60 | 60 | 98 | 162 | 4.60 |
| 125 | 5 | 90 | 112 | 194 | 8.60 | 90 | 112 | 194 | 8.60 |
| 150 | 6 | 106 | 132 | 217 | 13.20 | 106 | 132 | 217 | 13.20 |
| 200 | 8 | 140 | 177 | 274 | 26.30 | 140 | 177 | 274 | 26.30 |

All Dimensions are in "mm"

MATERIALS

| | |
|--|---|
| Body | ASTM A 216 Gr. WCB, ASTM A 351 Gr. CF8M |
| Disc & Cover | ASTM A276 Gr. 410 / 304 / 316 |
| Locator & Spring | SS 316 |
| Centring Ring | Spring Steel |
| Surface Protection for Carbon Steel Valves | Cold phosphating - Blackened |

NOTE:

- *Net Wt in Kg. approx. (without obligation).
- Please specify flow medium, working pressure, temperature & service conditions.
- Other materials not mentioned above & higher sizes are available on request
- Face to Face as per Manufacturer standard
- Valves to mount between Class 150 & Class 300 Flanges.
- Valves are self-centring type
- Valves can be supplied with IBR & soft seat arrangement
- In process of continuous improvement of products, the data given here in is subject to change



T.S. PUMPS & VALVES PVT.LTD.

B-490, Industrial Estate, Gokul Road,
Hubballi-580030, Karnataka, INDIA
Phone : +91-836-2331096 / 2210615
Email : sales@tsvalvesindia.com
Website : www.tsvalvesindia.com

TSPV: CAT-004/R-02
Date : 25/05/2017